

Drawing & Part No. TENGC000031 手動橢圓形把手	Description φ12.70xφ7.10-φ70.00-H25.00-#6-32THREADxT8	Rev. 0
---	--	-----------

Taipei Date : MAR./21/2014

螺絲牙以標準環規 #6-32 牙為標準 x 2

UNIT : MM

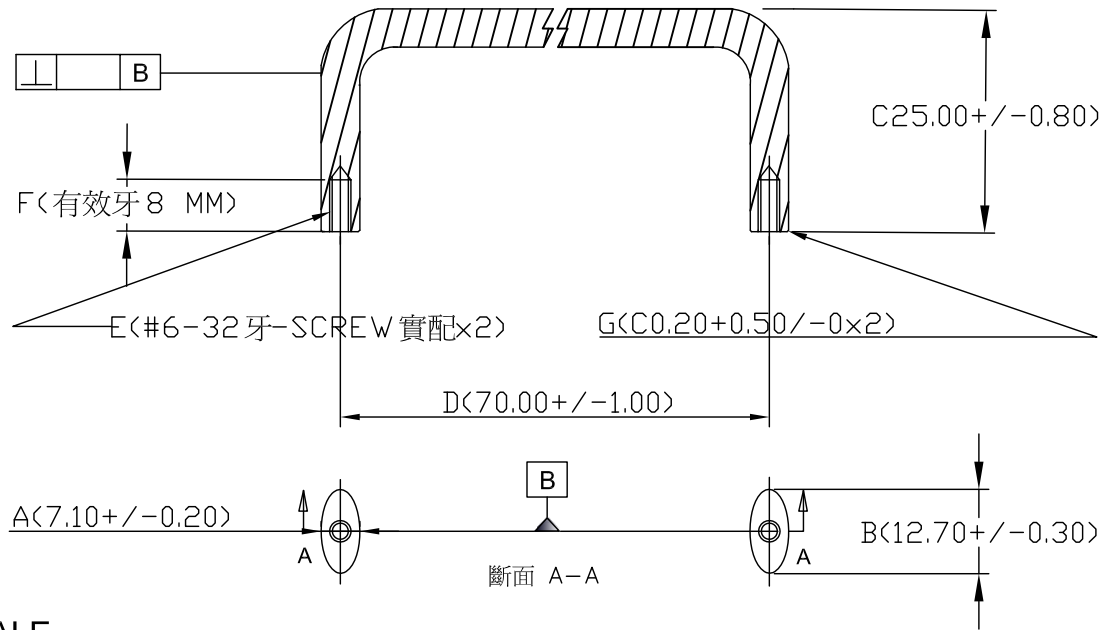

NOT TO SCALE

Materials	Specifications		Remarks	
AISI 6063 ALUMINUM ALLOY 鋁合金材質 (編號 6063)	A	7.10 +/- 0.20		
Hardness	B	12.70 +/- 0.30		
83 HV (REF. VALUED)	C	25.00 +/- 0.80		
Finish	D	70.00 +/- 1.00		
BLACK ANODIZING 黑色亮面陽極處理	E	#6-32 牙-SCREW 實配 x2		
Salt Spray Test	F	有攻牙 8 MM (孔深 10 MM)		
12 HOURS	G	C0.20 +0.50 / -0 (x2)		
Customer	H	X		
OTC	J	X		
Confirmed By	K	X		
Part No.			I	X
Description	φ12.70xφ7.10-φ70.00-H25.00-#6-32THREADxT8			

TENGSCREW CO., LTD.
鄧 記 有 限 公 司

DRAWN

CHECKED

APPROVED

Tommy
03.21.2014

Tommy
03.21.2014

Johnson
03.21.2014

Drawing & Part No. TENG000013手動橢圓形把手	Description $\varnothing 15.80 \times \varnothing 7.10 - \text{C}127.00 - \text{H}38.00 - \#10 - 32 \text{THREAD} \times \text{T}13$	Rev. 1
--	--	------------------

Taipei Date : JUNE/15/2013

螺絲牙以標準環規 #10-32 牙為標準 x 2

UNIT : MM

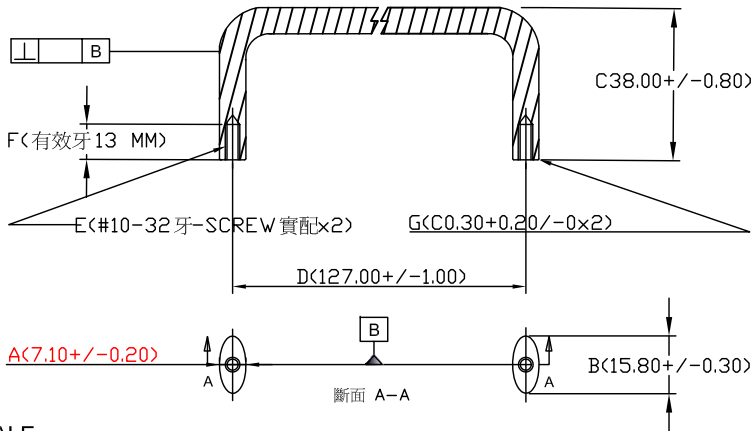

NOT TO SCALE

Materials	Specifications		Remarks	
AISI 6063 ALUMINUM ALLOY 鋁合金材質 (編號 6063)	A	7.10 +/- 0.20		
Hardness	B	15.80 +/- 0.30		
83 HV (REF. VALUED)	C	38.00 +/- 0.80		
Finish	D	127.00 +/- 1.00		
BLACK ANODIZING 黑色霧面陽極處理	E	#10-32 牙-SCREW 實配 x 2		
Salt Spray Test	F	有攻牙 13 MM (孔深 15 MM)		
12 HOURS	G	C0.30 + 0.20 / - 0 (x 2)		
Customer	H	X		
MTC	J	X		
Confirmed By	K	X		
Part No.			I	X
Description				

TENGSCREW CO., LTD.
 鄧 記 有 限 公 司

DRAWN

CHECKED

APPROVED

Tommy
06.13.2013

Tommy
06.13.2013

Johnson
06.15.2013

Drawing & Part No. TENGC000008 手動橢圓形把手	Description ∅12.70x∅7.10-∮76.20-H38.10-M4xP.0.70xT11	Rev. 0
---	---	-----------

Taipei Date : APR./19/2013

螺絲牙以標準環規 M4xP.0.70 MM 牙為標準 x2

UNIT : MM

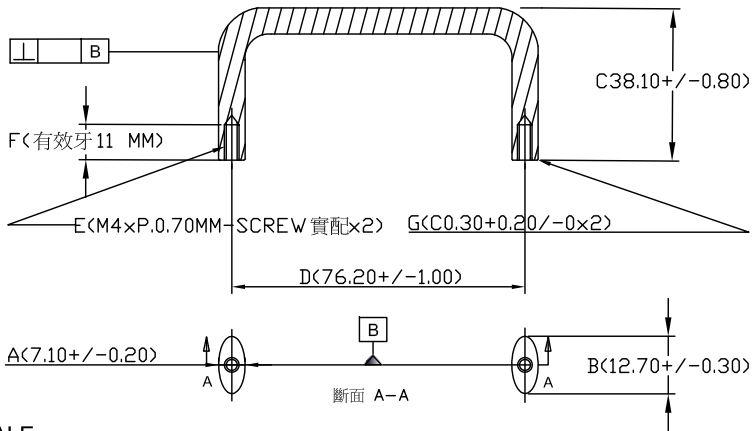

NOT TO SCALE

Materials	Specifications		Remarks
AISI 6063 ALUMINUM ALLOY 鋁合金材質 (編號 6063)	A	7.10 +/- 0.20	
Hardness 83 HV (REF. VALUED)	B	12.70 +/- 0.30	
Finish NATURAL ANODIZING 表面原色陽極處理	C	38.10 +/- 0.80	
	D	76.20 +/- 1.00	
Salt Spray Test 12 HOURS	E	M4xP.0.7MM牙-SCREW實配x2	
	F	有攻牙 11 MM (孔深 13 MM)	
Customer	G	C0.30+0.20/-0 (x2)	
Confirmed By	H	X	
	J	X	
Part No.	K	X	
Description	∅12.70x∅7.10-∮76.20-H38.10-M4xP.0.70xT11		I X

TENGSCREW CO., LTD.
鄧 記 有 限 公 司

DRAWN

CHECKED

APPROVED

Tommy
04.19.2013

Tommy
04.19.2013

Johnson
04.20.2013